

**B 100 102**

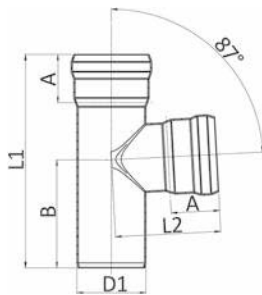

### 808/87

#### BRAGA 87°

- BRANCH 87°
- ABZWEIG 87°
- EMBRANCHEMENT 87°
- DERIVACIÓN M-H 87°

**MATERIAL:** AISI 316L - 1.4404

**GASKET:** EPDM cod. 826/GV (Ø 40 ÷ 65)  
EPDM cod. 826/G (Ø 80 ÷ 150)

**NORM:** EN 1124-3

CODE	DN	D1 mm	A mm	L1 mm	L2 mm	B mm	kg	
808040087	40	42	30	137	67	70	0,193	1
808050087	50	53	38	165	81	84	0,291	1
808065087	65	73	55	209	109	106	0,639	1
808080087	80	88,9	60	235	122	119	0,863	1
808100087	100	102	70	291	138	148	1,196	1
808125087	125	133	125	360	159	182	2,219	1
808150087	150	159	150	403	178	204	2,932	1

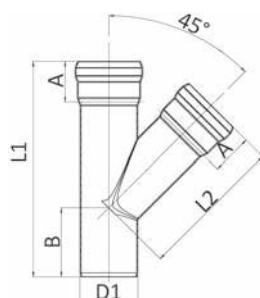

### 808/45

#### BRAGA 45°

- BRANCH 45°
- ABZWEIG 45°
- EMBRANCHEMENT 45°
- DERIVACIÓN M-H 45°

**MATERIAL:** AISI 316L - 1.4404

**GASKET:** EPDM cod. 826/GV (Ø 40 ÷ 65)  
EPDM cod. 826/G (Ø 80 ÷ 150)

**NORM:** EN 1124-3

**B 100 102**

CODE	DN	D1 mm	A mm	L1 mm	L2 mm	B mm	kg	
808040045	40	42	30	155	100	55	0,233	1
808050045	50	53	38	198	132,5	65	0,382	1
808065045	65	73	55	255	170	85	0,864	1
808080045	80	88,9	60	295	210	95	1,200	1
808100045	100	102	70	335	225	110	1,517	1
808125045	125	133	125	415	285	130	2,936	1
808150045	150	159	150	460	320	140	3,856	1